

LFP1200系列隔膜增压泵
1200GPD RO Diaphragm Booster Pump



产品特点 PRODUCT FEATURES

- 符合ROHS、CE、CQC认证
Compliant with RoHS, CE & CQC certification.
- 涉水部件均符合食品级要求
The wet parts complies with food grade requirements.
- 承压部件采用高强度塑料与金属材料
High strength plastic and metal pressure components.
- 密封部件采用进口材质
The materials of sealing parts are all imported.
- 低噪音、低振动、强动力直流电机配置
Equipped with strong impetus DC motor with low noise, low vibration.
- 电气、密封、增压等性能生产流程全控制
Whole process quality control in electrical, sealing and water producing.

产品参数 PRODUCT PARAMETERS

型号 Model	额定电压 Voltage	进水压力 Inlet pressure	工作压力 Working pressure	工作电流 Working current	工作流量 Working flow	开放流量 Open flow	封堵压力 Bypass pressure	最大电流 Maximum current	接口方式 Connection
LFP21200J (双出水)	36V DC	0.2MPa	0.7MPa	≤4.5A	≥5500ml/min	≥6500ml/min	1.05~1.2 MPa	≤5.5A	NPT3/8螺纹 3/8" NPT
LFP21200W				≤4.0A	≥6000ml/min	1.1~1.3 MPa			

流量曲线 FLOW CURVE

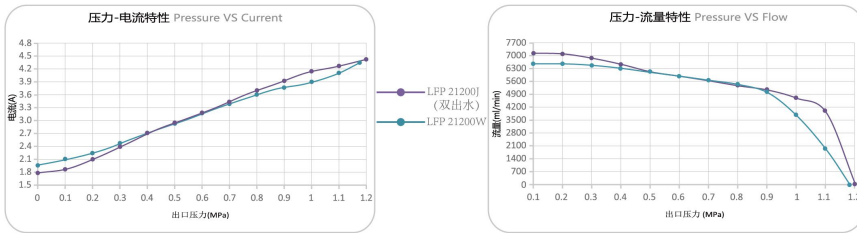

安装尺寸 MOUNTING DIMENSIONS(mm)

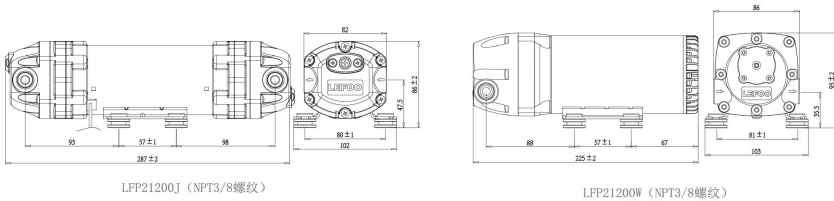

LFP21200J (NPT3/8螺纹)

LFP21200W (NPT3/8螺纹)

LFP1500系列隔膜增压泵
1500GPD RO Diaphragm Booster Pump



产品特点 PRODUCT FEATURES

- 符合ROHS、CE、CQC认证
Compliant with RoHS, CE & CQC certification.
- 涉水部件均符合食品级要求
The wet parts complies with food grade requirements.
- 承压部件采用高强度塑料与金属材料
High strength plastic and metal pressure components.
- 密封部件采用进口材质
The materials of sealing parts are all imported.
- 低噪音、低振动、强动力直流电机配置
Equipped with strong impetus DC motor with low noise, low vibration.
- 电气、密封、增压等性能生产流程全控制
Whole process quality control in electrical, sealing and water producing.

产品参数 PRODUCT PARAMETERS

型号 Model	额定电压 Voltage	进水压力 Inlet pressure	工作压力 Working pressure	工作电流 Working current	工作流量 Working flow	开放流量 Open flow	封堵压力 Bypass pressure	最大电流 Maximum current	接口方式 Connection
LFP21500W (双出水)	36V DC	0.2MPa	0.7MPa	≤5.0A	≥6000ml/min	≥7000ml/min	1.05~1.2 MPa	≤6.0A	NPT3/8螺纹 3/8" NPT

流量曲线 FLOW CURVE

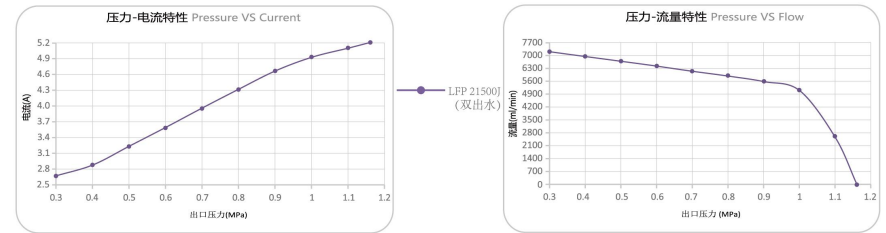

安装尺寸 MOUNTING DIMENSIONS(mm)

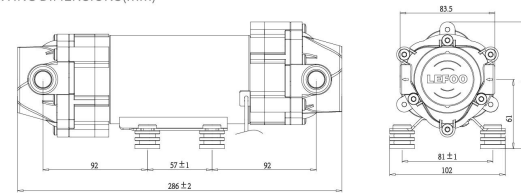

LFP21500W (NPT3/8螺纹)