

LFP0100W SERIES

Diaphragm Booster Pump •

Features

- Certification**
CE, RoHS, REACH, certifications
- Food Safety**
All parts contact with water are complies with FDA, NSF, or EU food grade
- High Stability**
Large water flow, compact size, stable pressure, long service life
- High Strength**
High strength plastic and metal materials
- High Performance Motors**
Low noise, low vibration, strong power
- 100% Quality Control**
100% quality control for whole production process



Flow Curve

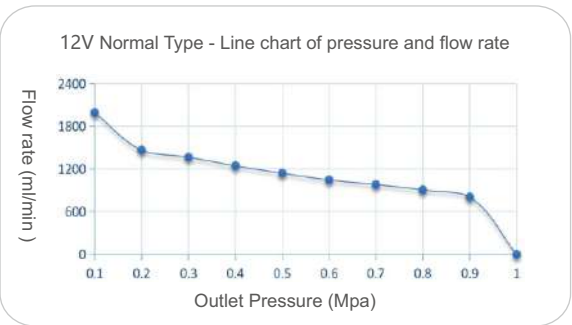
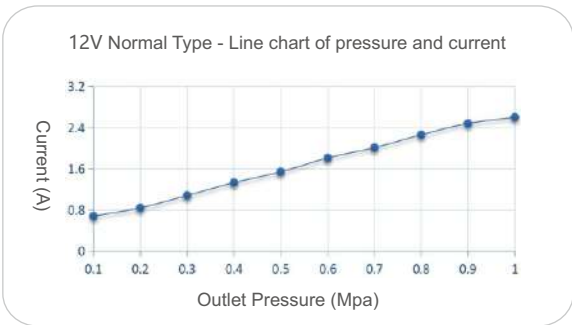

Product Specifications

Model	Voltage	Inlet Water Pressure	Working Pressure	Working Current	Working Flow Rate	Open Flow	Bypass Pressure	Maximum Current
LFP0100W	12VDC	0.2MPa	0.5MPa	≤2.1A	≥980mL/min	≥2000mL/min	0.8-1.0MPa	≤2.8A

Connection

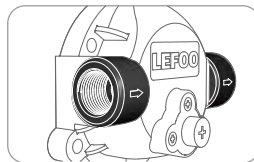

(3/8" NPT)



(3/8" NPT"O")

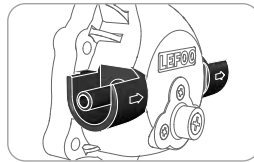

(1/4" Male quick connector)

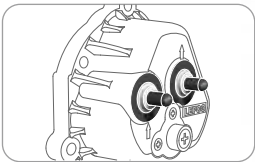

(1/4" Top female quick connector)



Mounting Dimension: mm

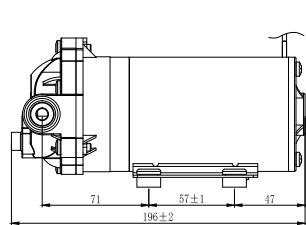

LFP0100W (3/8"NPT)

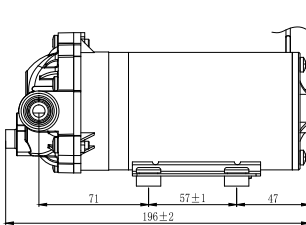
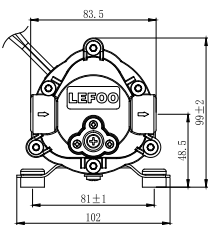

LFP0100W (3/8" NPT"O")

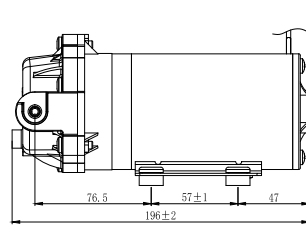
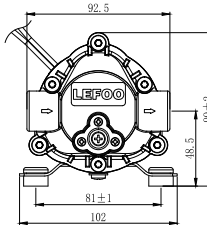

LFP0100W (1/4" MALE QUICK CONNECTOR)

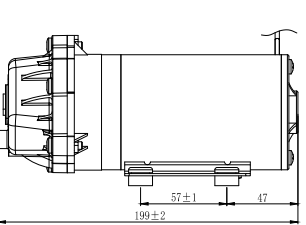
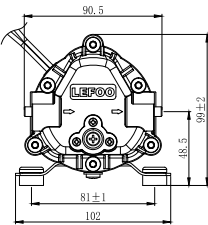

LFP0100W (1/4" TOP FEMALE QUICK CONNECTOR)

